

Stone Gateposts inside Graves Park



Information recorded June 2019

Tony Spillane

GATEPOST LOCATIONS



1849 map with approximate location of gateposts (numbered in red)



Gatepost 1

- This pair of gateposts are located close to the eastern end of the three ponds, near the animal farm.
- The two gateposts line up with the existing farm track, and the boundary line on the 1849 map.
- They appear to have been functional, as they include hinges and a clasp for the gate, and carved square hole features on the outside surfaces for attaching fences.
- One post appears to have been re-cycled, as it has redundant features (carved hole and hinge point)

GATE POST NUMBER: GPOST 1

DATE: 27/6/2019

LOCATION: END OF TOP LAKE, BY ANIMAL FARM.

GPS POINTS: GPOST 1 HINGE
GPOST 1 CLASP

COMPASS ORIENTATION BETWEEN POSTS (FROM HINGE TO CLASP): 240° SW

DISTANCE BETWEEN POSTS: 2.68 m.

HINGE POST:

OUTSIDE
FACE

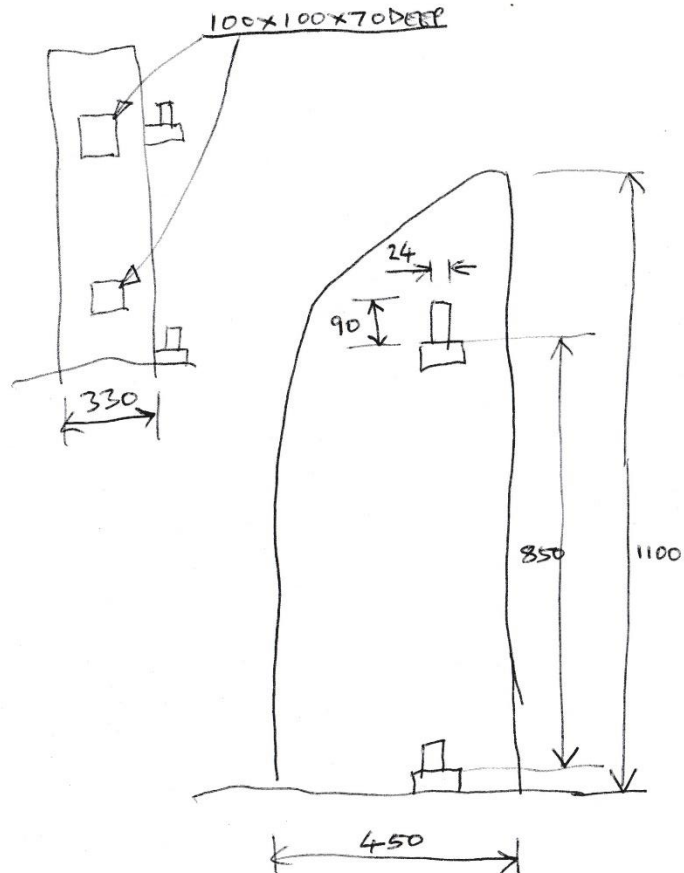

INSIDE
FACE

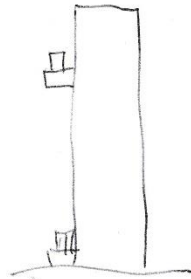

CLASP POST:

INSIDE
FACE

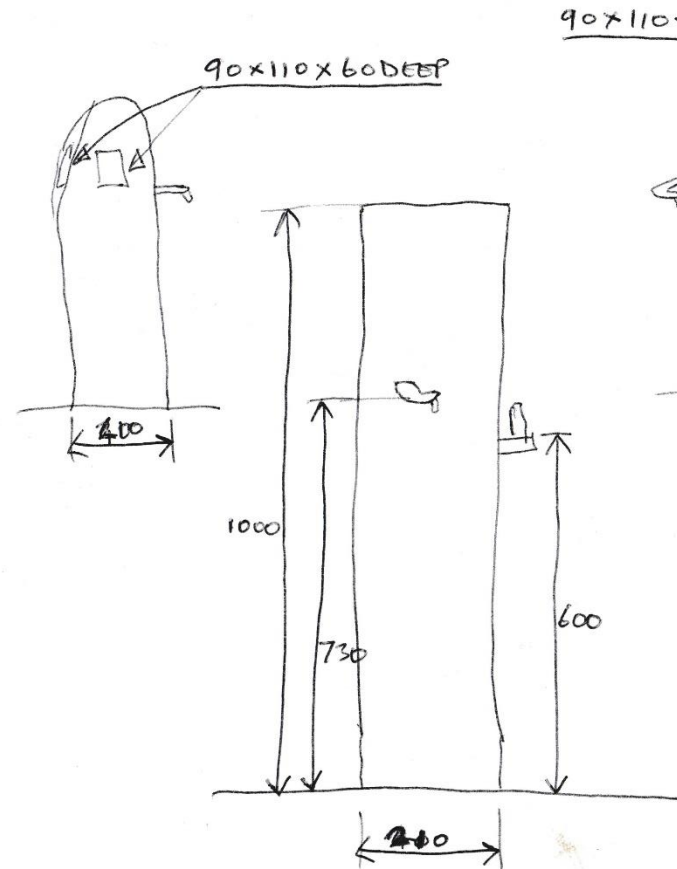

OUTSIDE
FACE

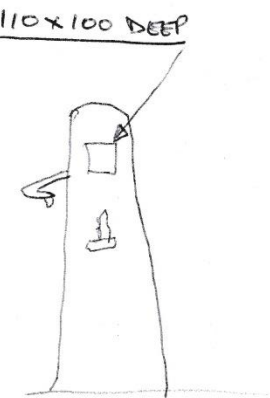

Gatepost 1 - photos



Gatepost 2

- This pair of gateposts are located on the track over the damn between the two larger ponds
- They appear to align with a boundary line on the 1849 map, and would have been used to separate land north and south of the ponds
- The gateposts appear to have been functional, as they include hinges, clasp and features on the outside faces for attaching a fence
- The hinge post has several small inserts on two adjacent sides, with the inserts alternating as they go up the post (see photo)
- The lower hinge is a pair of vertical 'stays', which would have limited the gate opening angle
- The clasp was designed to allow the gate to open in either direction.

GATE POST NUMBER: GPOST 2

DATE: 27/6/2019

LOCATION:

GPS POINTS: GPOST 2 HINGE
GPOST 2 CLASP

COMPASS ORIENTATION BETWEEN POSTS (FROM HINGE TO CLASP): 233° SW

DISTANCE BETWEEN POSTS: 3.15 m

HINGE POST:

CLASP POST:

OUTSIDE
FACE

INSIDE
FACE

INSIDE
FACE

OUTSIDE
FACE

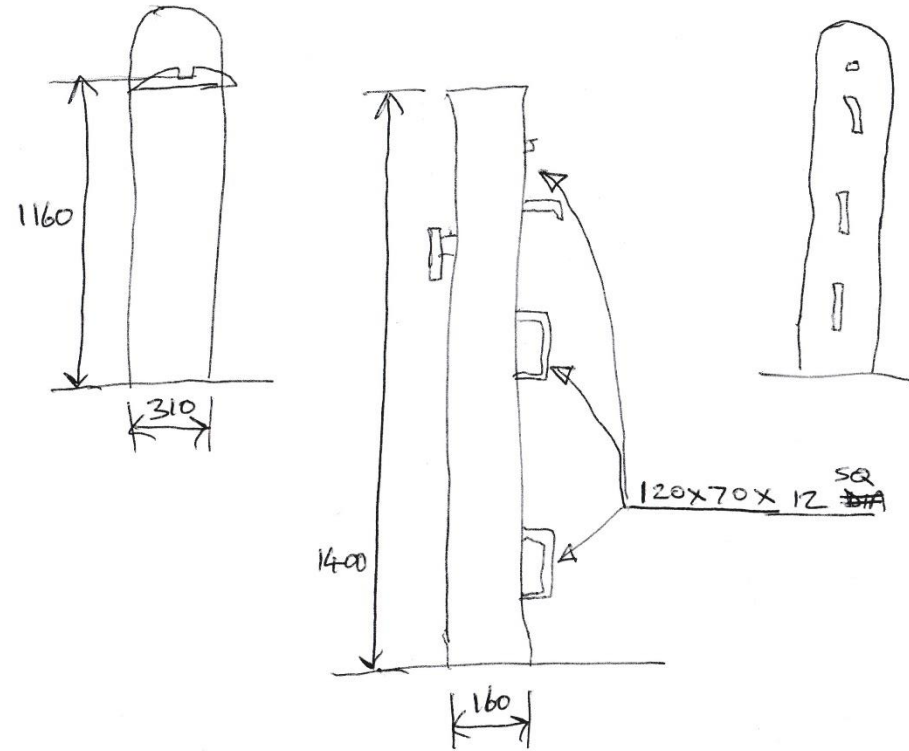
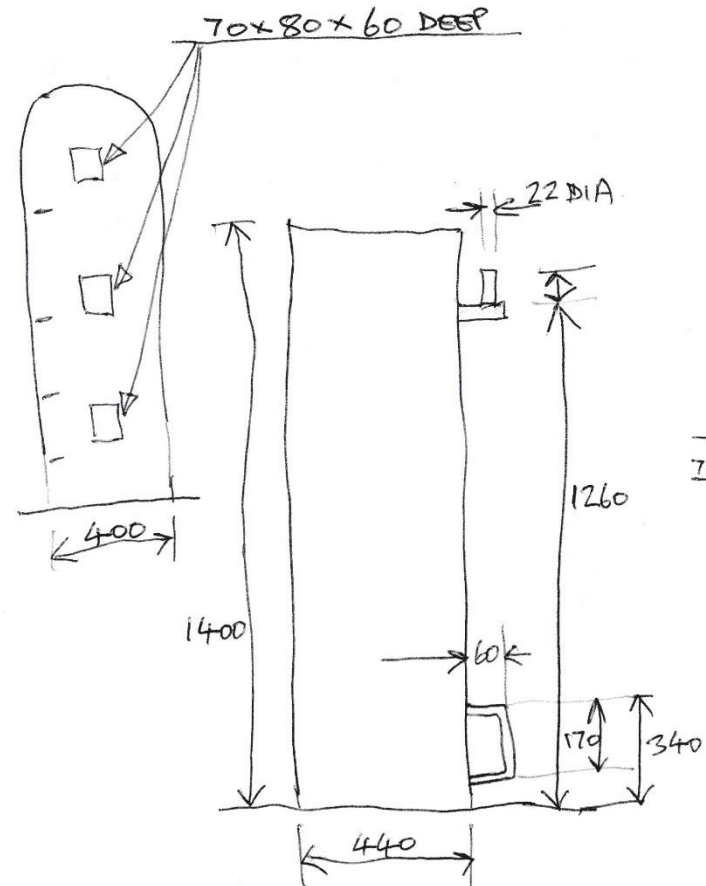

Gatepost 2 photos



Gatepost 3

- This single gatepost is on the tarmacked part of the 'Old London Road'
- It features a large gate clasp
- There is also a carved feature on one side, that looks like it had a cover plate, and some rotating mechanism (horizontal pivot pin)
- Although the gatepost is on the eastern side of the tarmac track, it might have been on the western side of the original track, judging by the gap to the banked up ridge (see photo)
- The gatepost seems to have been well made, with ridged carvings on each corner
- It appears that this gatepost might be located at the junction of two boundaries on the 1849 map

GATE POST NUMBER: GPOST 3

DATE: 27/6/2019

LOCATION: ON OLD LONDON ROAD

GPS POINTS: GPOST 3 CLASP

COMPASS ORIENTATION BETWEEN POSTS (FROM HINGE TO CLASP):

N/A

DISTANCE BETWEEN POSTS:

N/A

HINGE POST:

CLASP POST:

OUTSIDE
FACE

INSIDE
FACE

INSIDE
FACE

OUTSIDE
FACE

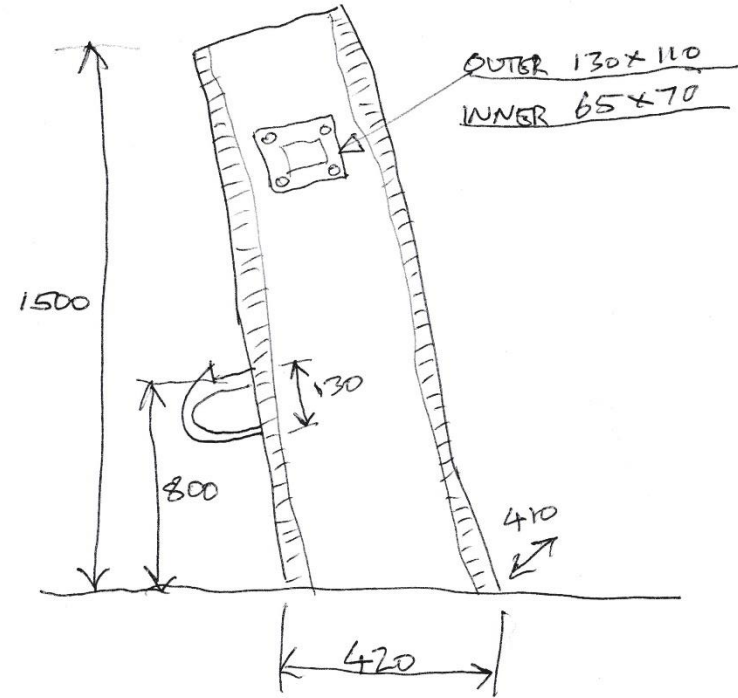

Gatepost 3 photos



Gatepost 4

- This is a single gatepost, located near the Charles Ashmore car park
- The post is devoid of any hinge or clasp features, or any evidence that it ever had such features.
- It appears to act as a sign for features on the other side of the track.
- These features include stonework / wall / bank edging, and a horizontal tree trunk with major wood carving work:
 - A domed end
 - A curved start to removing half of the trunk's diameter
(see diagram & photos)

GATE POST NUMBER: GPOST 4

DATE: 27/6/2019

LOCATION: NEAR CHARLES ASHMORE CAR PARK

GPS POINTS: GPOST 4

COMPASS ORIENTATION BETWEEN POSTS (FROM HINGE TO CLASP): N/A

DISTANCE BETWEEN POSTS:

N/A

HINGE POST:

CLASP POST:

OUTSIDE
FACE

INSIDE
FACE

INSIDE
FACE

OUTSIDE
FACE

NO FEATURES OR MARKINGS
(NO HINGE OR CLASP)

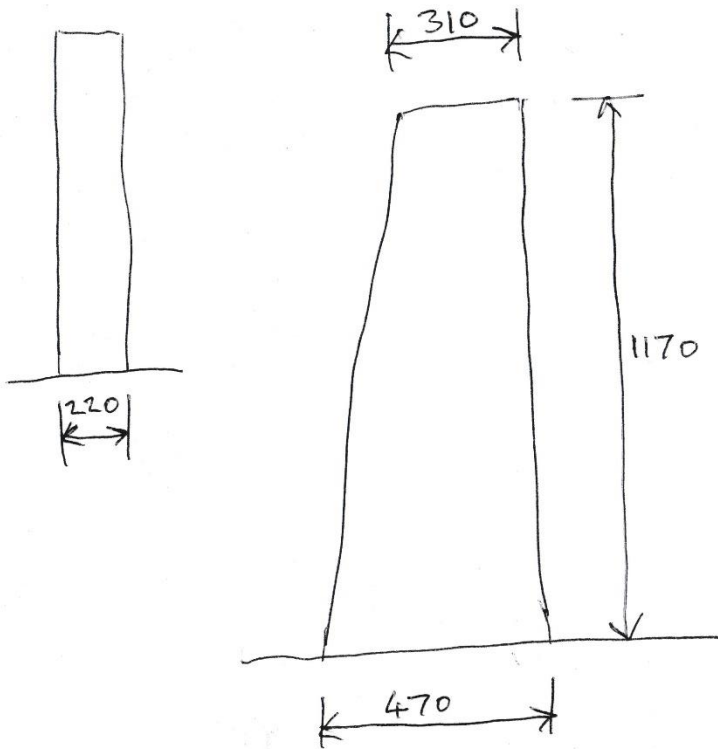

CARVED WOODEN TRUNK (OPPOSITE GATEPOST 4)

DOMED END

CUT AWAY PORTION OF TRUNK

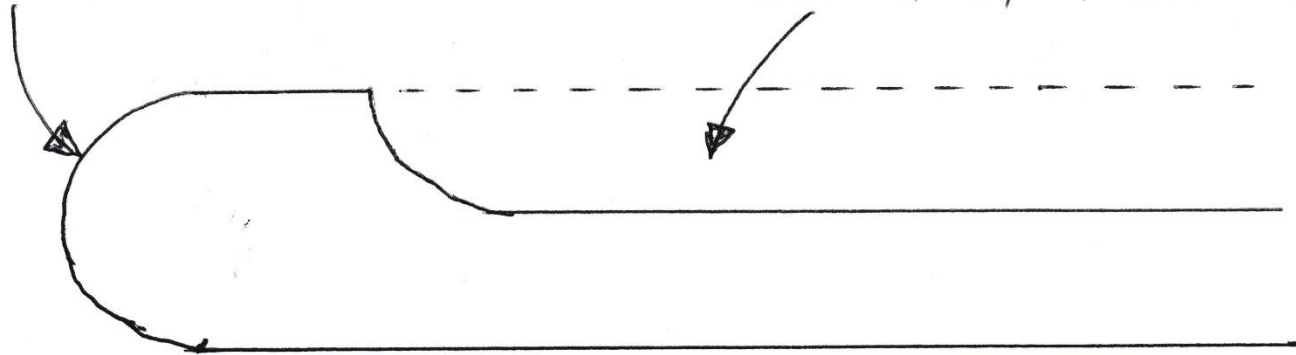

SIDE VIEW

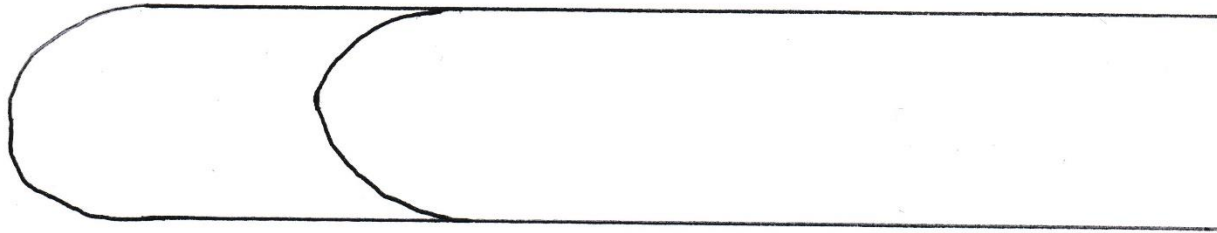

TOP VIEW

27/6/2019.

Gatepost 4 photos



Gatepost 5

- These gateposts are located at the northern end of the small 'pack horse bridge', at the southern end of field 479
- They form a functioning pair of gateposts, with hinges and clasp. The hinges and clasp are not 'inside' the posts, but on their northern sides. (See also gatepost 1 & 6)
- There doesn't appear to be any signs of redundant features, or recycling.

GATE POST NUMBER: GPOST 5

DATE: 27/6/2019

LOCATION: OVER PACK HORSE BRIDGE (TOTEM POLE XROADS)

GPS POINTS: GPOST 5 HINSE
GPOST 5 CLASP

COMPASS ORIENTATION BETWEEN POSTS (FROM HINSE TO CLASP): 130° SE

DISTANCE BETWEEN POSTS: 2.63m

CLASP ~~HINSE~~ POST:

HINSE ~~CLASP~~ POST:

OUTSIDE
FACE

INSIDE
FACE

INSIDE
FACE

OUTSIDE
FACE

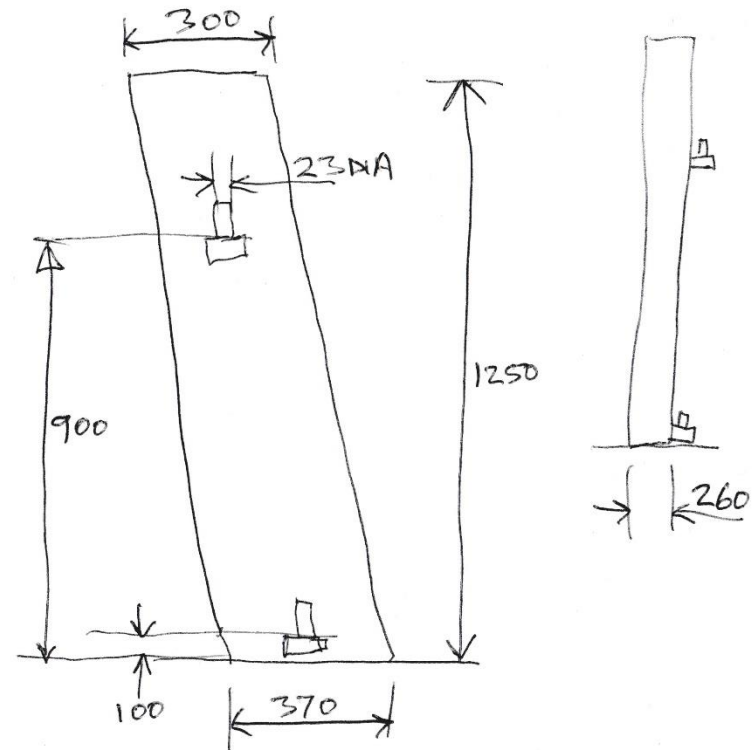
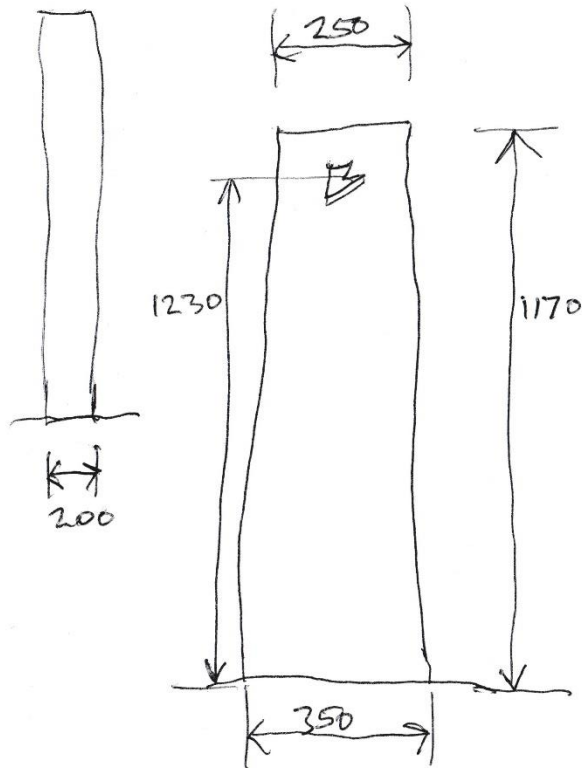

Gatepost 5 photos



Gatepost 6

- This pair of gateposts are located close to the stream, near the bottom of field no. 480.
- They appear to be functional, as they include hinges on one post (although the bottom hinge is not visible, possibly now below the ground level), the other post having a feature that might have been the mounting for a clasp.
- Unusually, the top hinge rod has a square hole in it, as used nowadays to fit a split pin, to prevent gate removal
- As there is a significant bank between the stream and the fields (which have their own boundary banks) to the north, this gate might have been on an old trackway running east – west, beside the north bank of the stream. This could have served access to fields 480 & 481 from the 'Old London Road'

GATE POST NUMBER: GPOST 6

DATE: 27/6/2019

LOCATION: BOTTOM OF FIELD 480, BESIDE RIVER.

GPS POINTS: GPOST 6 HINGE
GPOST 6 CLASP

COMPASS ORIENTATION BETWEEN POSTS (FROM HINGE TO CLASP): 153° SE

DISTANCE BETWEEN POSTS: 2.57m

CLASP ~~HINGE~~ POST:

HINGE ~~CLASP~~ POST:

OUTSIDE
FACE

INSIDE
FACE

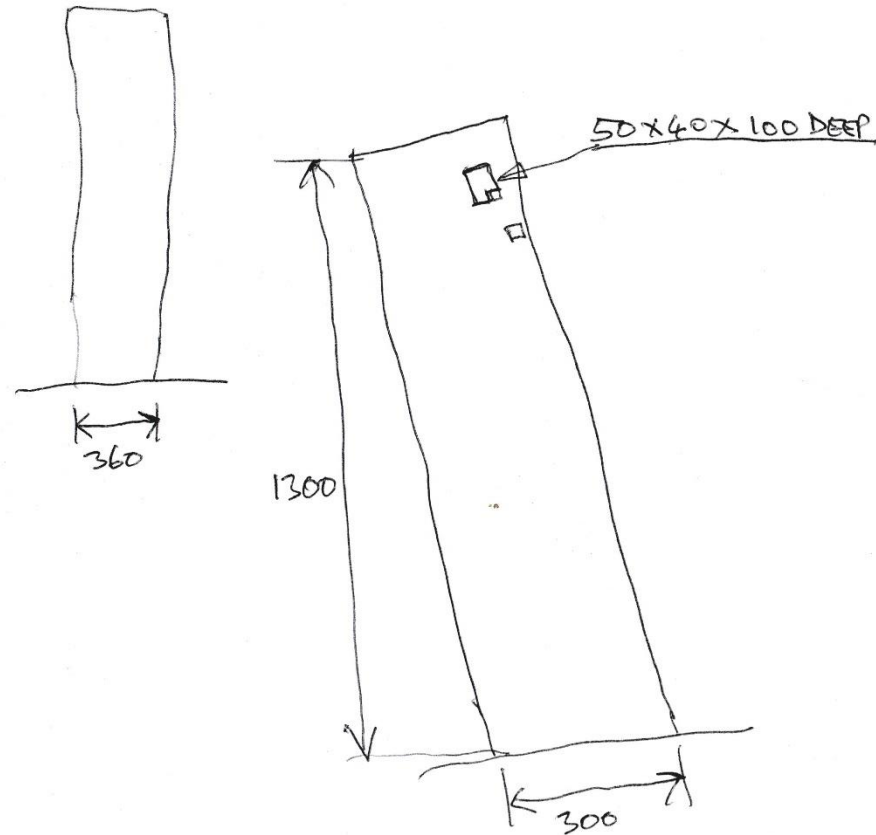

INSIDE
FACE

OUTSIDE
FACE

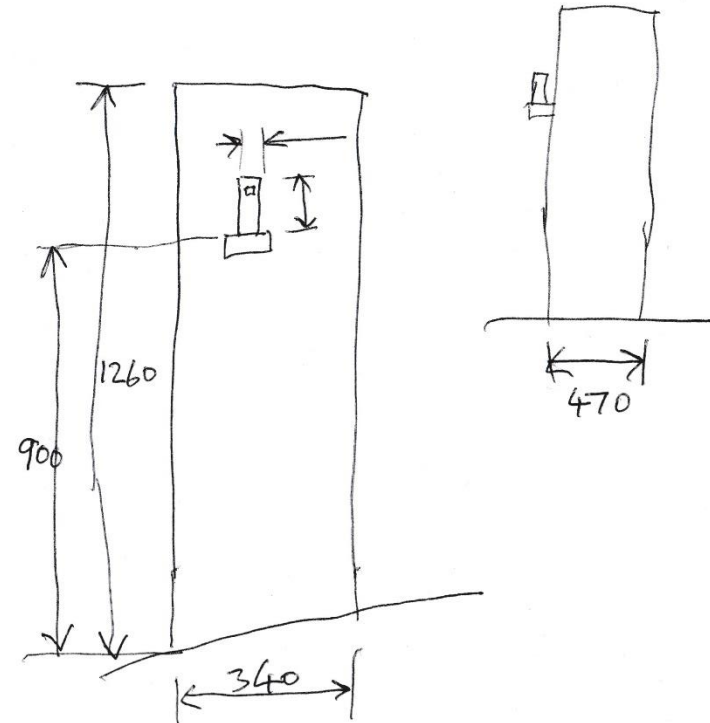

Gatepost 6 photos



Graves Park Gateposts – Comparison Chart

Gatepost Number	1	2	3	4	5	6
Gap between posts	2.68m	3.15m	N/A	N/A	2.63m	2,57m
Compass orientation (Hinge post to clasp post)	240 deg SW	233 deg SW	N/A	N/A	130 deg SE	153 deg SE
Post height (above ground)	1000 1100	1400 1400	1500	1170	1170 1250	1300 1260
Post base dimensions	450 x 330 210 x 400	440 x 400 160 x 310	420 x 410	470 x 220	350 x 200 370 x 260	300 x 360 340 x 470
Gate functionality:-						
Hinges	Yes	Yes	No	No	Yes	Yes
Clasp	Yes	Yes	Yes	No	Yes	Possible mount
Fence location points	Yes	Yes	No	No	No	No
Evidence re-cycled	Yes	No	No	No	No	No
Other features	No	No	Yes	No	No	Possible

(In each case, the gate itself would have been approximately 10 foot wide)